

GN 709.15 | Pendelelemente mit Gewindezapfen

Edelstahl



- 1
- 2
- 3
- 4
- 5
- 6
- 7
- 8
- 9
- 10
- 11
- 12
- 13
- 14
- 15
- 16
- 17
- 18

MATERIAL

Edelstahl AISI 431 gehärtet

ELASTISCHES ELEMENT

Polyurethan (PUR).

STANDARDAUSFÜHRUNGEN

Kugel Edelstahl AISI 420C vernickelt:

- **GN 709.15-B**: Druckfläche geriffelt ohne selbsttätige Rückstellung.
- **GN 709.15-BR**: Druckfläche geriffelt ohne selbsttätige Rückstellung, mit selbsttätiger Rückstellung.

Kugeln Stahl vernickelt:

- **GN 709.15-RH**: Druckfläche geriffelt ohne selbsttätige Rückstellung.
- **GN 709.15-RRH**: Druckfläche geriffelt ohne selbsttätige Rückstellung, mit selbsttätiger Rückstellung.

FUNKTIONEN UND ANWENDUNGEN

Pendelelemente GN 709.15 werden als bewegliche Auflagen oder Druckstücke zum Spannen von Werkstücken verwendet.

Maximale Kugelneigung = 9°.

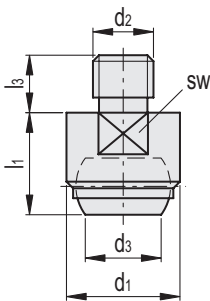

GN 709.15-B

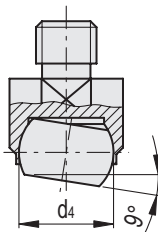

GN 709.15-BR

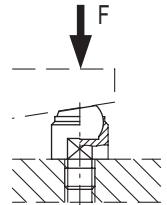
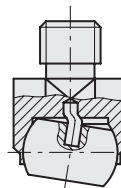

GN 709.15-B



| Code | Artikelnummer | d1 | d2 | d3 | d4 | l1 ±0.02 | l3 | sw | Max. statische Last F [kN] | ⚖️ |
|----------|--------------------|----|-----|------|----|----------|----|----|----------------------------|-----|
| GN.76251 | GN 709.15-13-M6-B | 13 | M6 | 7.2 | 10 | 13 | 8 | 11 | 10 | 13 |
| GN.76253 | GN 709.15-13-M8-B | 13 | M8 | 7.2 | 10 | 13 | 8 | 11 | 10 | 13 |
| GN.76261 | GN 709.15-20-M8-B | 20 | M8 | 10.5 | 16 | 18 | 10 | 17 | 25 | 38 |
| GN.76263 | GN 709.15-20-M10-B | 20 | M10 | 10.5 | 16 | 18 | 10 | 17 | 25 | 40 |
| GN.76265 | GN 709.15-20-M12-B | 20 | M12 | 10.5 | 16 | 18 | 12 | 17 | 25 | 43 |
| GN.76271 | GN 709.15-30-M16-B | 30 | M16 | 20 | 25 | 27 | 16 | 27 | 90 | 150 |
| GN.76276 | GN 709.15-50-M20-B | 50 | M20 | 34.5 | 40 | 35 | 20 | 41 | 165 | 488 |
| GN.76281 | GN 709.15-50-M24-B | 50 | M24 | 34.5 | 40 | 35 | 24 | 41 | 165 | 512 |

GN 709.15-BR



| Code | Artikelnummer | d1 | d2 | d3 | d4 | l1 ±0.02 | l3 | sw | Max. statische Last F [kN] | ⚖️ |
|----------|---------------------|----|-----|------|----|----------|----|----|----------------------------|-----|
| GN.76252 | GN 709.15-13-M6-BR | 13 | M6 | 7.2 | 10 | 13 | 8 | 11 | 10 | 12 |
| GN.76256 | GN 709.15-13-M8-BR | 13 | M8 | 7.2 | 10 | 13 | 8 | 11 | 10 | 13 |
| GN.76259 | GN 709.15-20-M8-BR | 20 | M8 | 10.5 | 16 | 18 | 10 | 17 | 25 | 37 |
| GN.76264 | GN 709.15-20-M10-BR | 20 | M10 | 10.5 | 16 | 18 | 10 | 17 | 25 | 38 |
| GN.76268 | GN 709.15-20-M12-BR | 20 | M12 | 10.5 | 16 | 18 | 12 | 17 | 25 | 42 |
| GN.76272 | GN 709.15-30-M16-BR | 30 | M16 | 20 | 25 | 27 | 16 | 27 | 90 | 147 |
| GN.76277 | GN 709.15-50-M20-BR | 50 | M20 | 34.5 | 40 | 35 | 20 | 41 | 165 | 482 |
| GN.76282 | GN 709.15-50-M24-BR | 50 | M24 | 34.5 | 40 | 35 | 24 | 41 | 165 | 511 |

Maschinenelemente

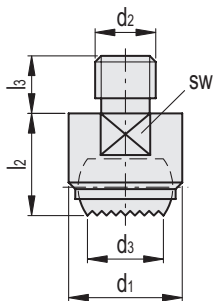

GN 709.15-RH

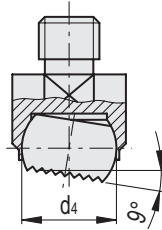

GN 709.15-RRH

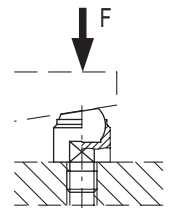
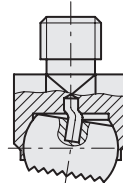

GN 709.15-RH

INOX STAINLESS STEEL

| Code | Artikelnummer | d1 | d2 | d3 | d4 | l2 ±0.1 | l3 | sw | Max. statische Last F [kN] | |
|----------|---------------------|----|-----|------|----|---------|----|----|----------------------------|-----|
| GN.76254 | GN 709.15-13-M6-RH | 13 | M6 | 8.3 | 10 | 13 | 8 | 11 | 10 | 14 |
| GN.76257 | GN 709.15-13-M8-RH | 13 | M8 | 8.3 | 10 | 13 | 8 | 11 | 10 | 16 |
| GN.76260 | GN 709.15-20-M8-RH | 20 | M8 | 12.8 | 16 | 18 | 10 | 17 | 25 | 49 |
| GN.76266 | GN 709.15-20-M10-RH | 20 | M10 | 12.8 | 16 | 18 | 10 | 17 | 25 | 51 |
| GN.76269 | GN 709.15-20-M12-RH | 20 | M12 | 12.8 | 16 | 18 | 12 | 17 | 25 | 54 |
| GN.76273 | GN 709.15-30-M16-RH | 30 | M16 | 20 | 25 | 27 | 16 | 27 | 90 | 187 |
| GN.76278 | GN 709.15-50-M20-RH | 50 | M20 | 34.5 | 40 | 35 | 20 | 41 | 165 | 632 |
| GN.76283 | GN 709.15-50-M24-RH | 50 | M24 | 34.5 | 40 | 35 | 24 | 41 | 165 | 660 |

GN 709.15-RRH

INOX STAINLESS STEEL

| Code | Artikelnummer | d1 | d2 | d3 | d4 | l2 ±0.1 | l3 | sw | Max. statische Last F [kN] | |
|----------|----------------------|----|-----|------|----|---------|----|----|----------------------------|-----|
| GN.76255 | GN 709.15-13-M6-RRH | 13 | M6 | 8.3 | 10 | 13 | 8 | 11 | 10 | 14 |
| GN.76258 | GN 709.15-13-M8-RRH | 13 | M8 | 8.3 | 10 | 13 | 8 | 11 | 10 | 16 |
| GN.76262 | GN 709.15-20-M8-RRH | 20 | M8 | 10.5 | 16 | 18 | 10 | 17 | 25 | 48 |
| GN.76267 | GN 709.15-20-M10-RRH | 20 | M10 | 10.5 | 16 | 18 | 10 | 17 | 25 | 49 |
| GN.76270 | GN 709.15-20-M12-RRH | 20 | M12 | 10.5 | 16 | 18 | 12 | 17 | 25 | 53 |
| GN.76274 | GN 709.15-30-M16-RRH | 30 | M16 | 20 | 25 | 27 | 16 | 27 | 90 | 190 |
| GN.76279 | GN 709.15-50-M20-RRH | 50 | M20 | 34.5 | 40 | 35 | 20 | 41 | 165 | 639 |
| GN.76284 | GN 709.15-50-M24-RRH | 50 | M24 | 34.5 | 40 | 35 | 24 | 41 | 165 | 637 |